

SITE INFORMATION

EXISTING APARTMENTS	51 UNITS
PARKING BAY SIZE:	9'x18'
MINIMUM AISLE WIDTH:	24'
PROPOSED NUMBER OF SPACES:	70
PROPOSED NUMBER OF GARAGE SPACES:	24
PROPOSED NUMBER OF HANDICAP SPACES:	4
TOTAL	98
PROPOSED APARTMENTS	24 UNITS
PROPOSED NUMBER OF OFFSTREET SPACES:	57
PROPOSED NUMBER OF GARAGE SPACES:	0
APARTMENT HOMES	6 UNITS
PROPOSED NUMBER OF OFFSTREET SPACES:	12
PROPOSED NUMBER OF GARAGE SPACES:	12
RESIDENTIAL	10 LOTS
MINIMUM FRONT YARD SETBACK:	25'
MINIMUM SIDE YARD SETBACK:	6'
MINIMUM REAR YARD SETBACK:	20'

No.	By	Date
9	BGH	7/24/24
8	PBY	04/19

Submittal / Revision

PDD Modification Initial Submission July 2024
 Revised Trash Enclosure at Apartment Building

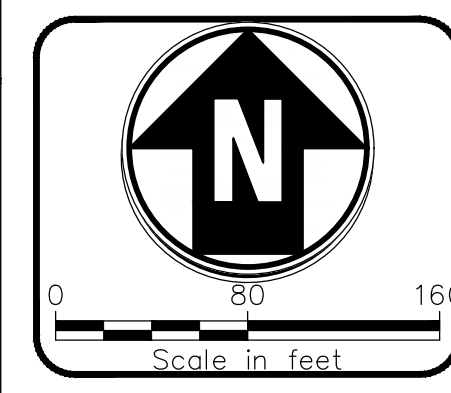

J. ALBERICI & SONS, INC.
 8266 WARBLER WAY, G-2
 LIVERPOOL, NEW YORK 13090

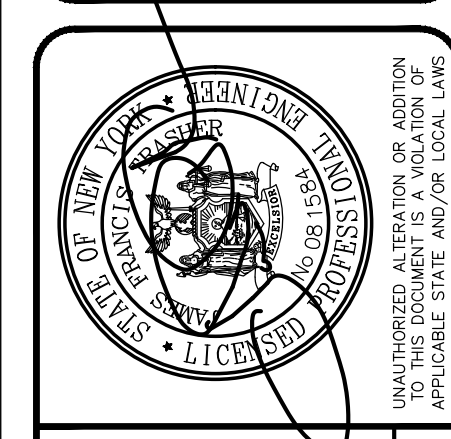



 One Park Plaza, 300 South Park Street, Suite 600
 315-471-3950 • www.jalberici.com

Designed: ZTP
 Drawn: ZTP
 Checked: JFT

JOBES ISLAND DEVELOPMENT
 VILLAGE OF BALDWINVILLE COUNTY OF ONONDAGA STATE OF NEW YORK
OVERALL LAYOUT PLAN
 Issue Date: 1/26/15 Project No.: 17076 Scale: AS SHOWN

C-5.0

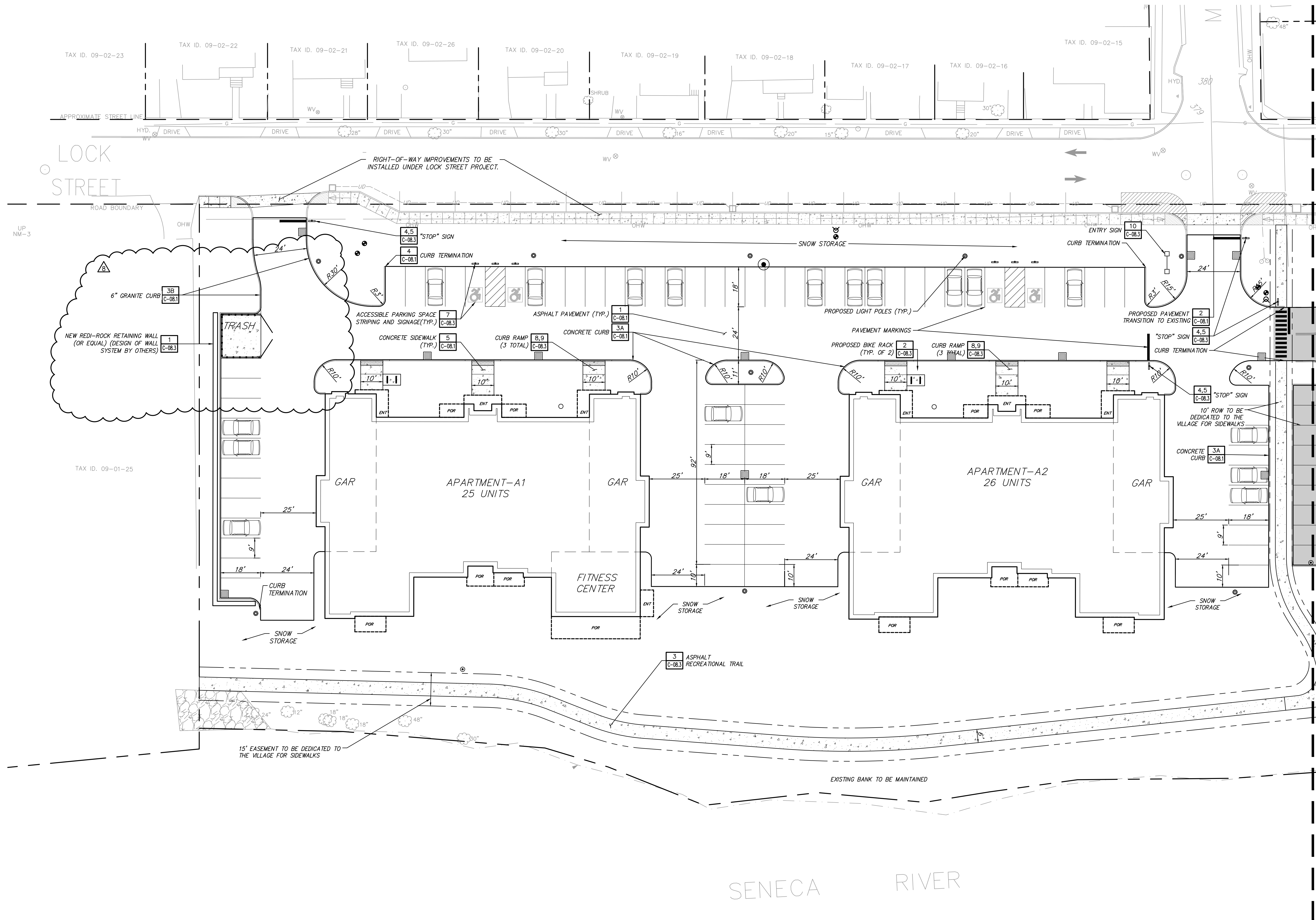
File: V:\PROJECTS\SNY17076\CADD\ACAD\V06ES ISLAND - BVILLE\SHEET FILES\2024 SHEET FILES\17076_V06ES ISLAND_C-05_APT.DWG
 Saved: 7/9/2024 11:50:34 AM Plotted: 7/9/2024 12:24:46 PM User: Harrell, Benjamin



MATCHLINE: SEE SHEET C-06.1

No.	Submittal / Revision	By	Date
9	PDD Modification Initial Submission July 2024	BGH	JFT 7/29/24
8	Revised Trash Enclosure at Apartment Building	PBY	JFT 04/19

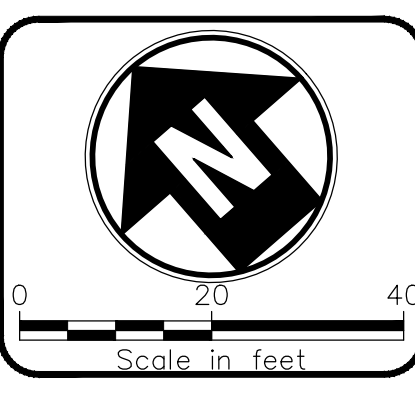

J. ALBERICI & SONS, INC.
 8266 WARBLER WAY, G-2
 LIVERPOOL, NEW YORK 13090

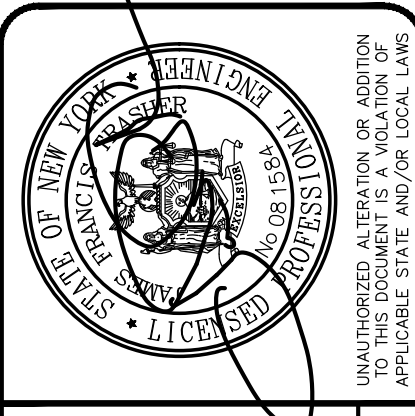



Drawn Copyright © 2023
 One Park Plaza, 300 South at 1520 West, Suite 600
 311-671-3928 • www.gmausa.com
 Designer: ZTP Drawn: ZTP Checked: JFT

FOBES ISLAND DEVELOPMENT
 VILLAGE OF BALDWINVILLE COUNTY OF ONONDAGA STATE OF NEW YORK
SITE LAYOUT PLAN
 Issue Date: 1/26/15 Project No.: 17076 Scale: AS SHOWN

C-5.1

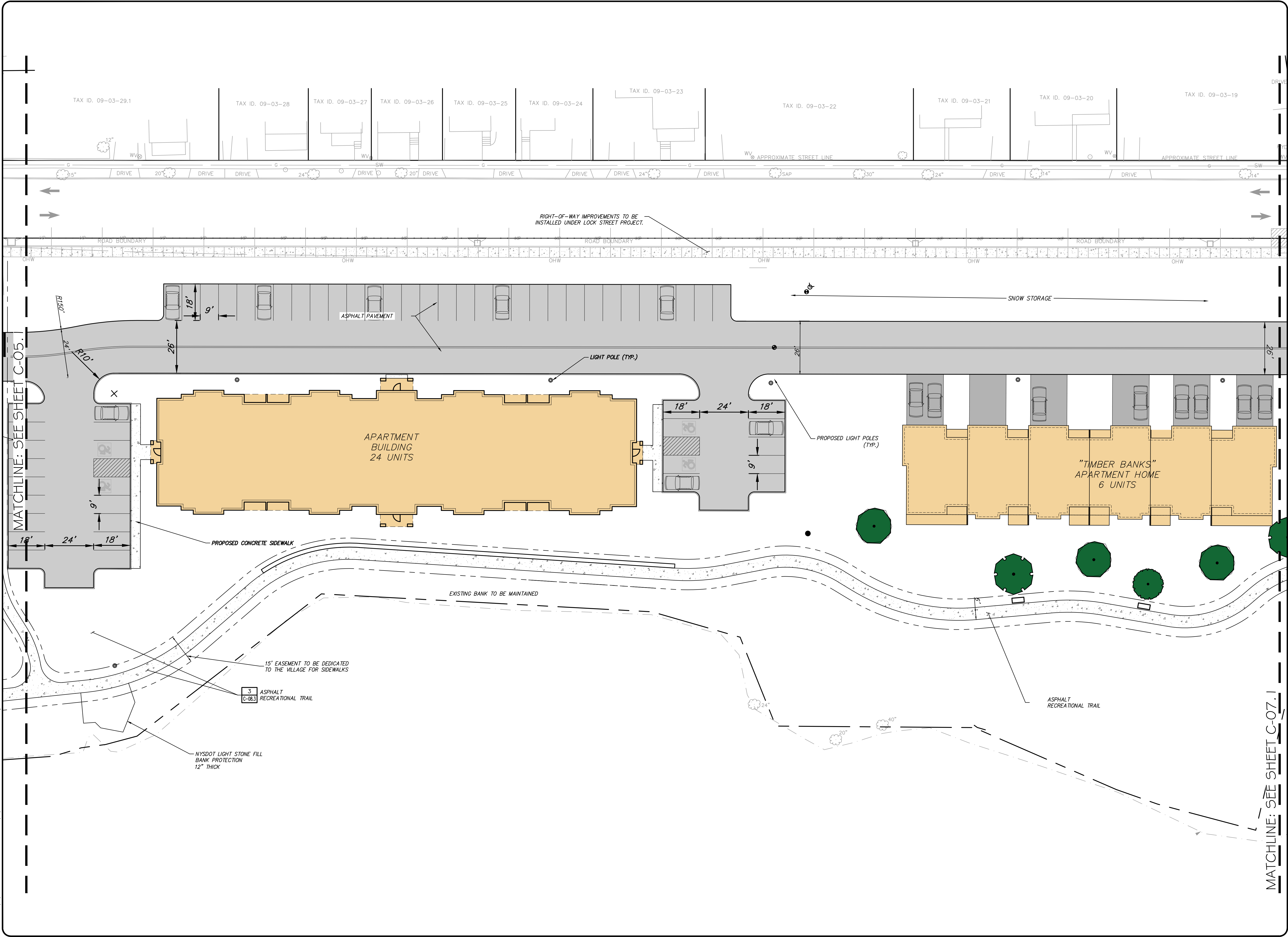
File: V:\PROJECTS\SNY17076\CADD\ACAD\FORES ISLAND - BVILLE\SHEET FILES\2024 SHEET FILES\17076_FORES ISLAND_C-06_APT HOMES.DWG
 Saved: 7/9/2024 12:13:43 PM Plotted: 7/9/2024 12:24:53 PM User: Herrell, Benjamin



No.	Submitted / Revision	By	Date
9	PDD Modification Initial Submission July 2024	BGH	JFT 7/29/24
8	Revised Trash Enclosure at Apartment Building	PBY	JFT 04/19

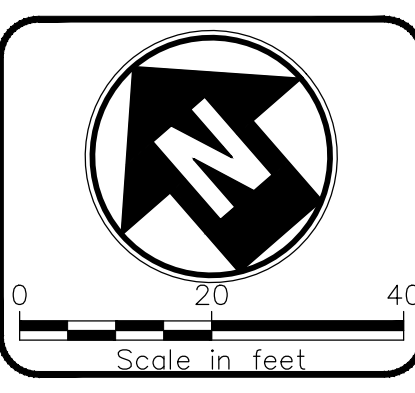

J. ALBERICI & SONS, INC.
 8266 WARBLER WAY, G-2
 LIVERPOOL, NEW YORK 13090

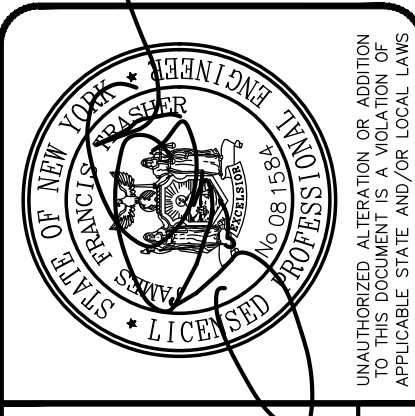

Drawn: ZTP
 Designee: ZTP
 Drawn: ZTP
 Checked: JFT

FORES ISLAND DEVELOPMENT
 VILLAGE OF BALDWINVILLE COUNTY OF ONONDAGA STATE OF NEW YORK
SITE LAYOUT PLAN
 Issue Date: 1/26/15 Project No.: 17076 Scale: AS SHOWN

C-6.1

File: V:\PROJECTS\NY\17076\CADD\CAD\JOBES ISLAND - BVILLE\SHEET FILES\2024 - SHEET FILES\17076_JOBES ISLAND_C-07-SINGLE FAMDWG

Saved: 7/9/2024 12:23:16 PM Plotted: 7/9/2024 12:24:59 PM User: Herrell, Benjamin

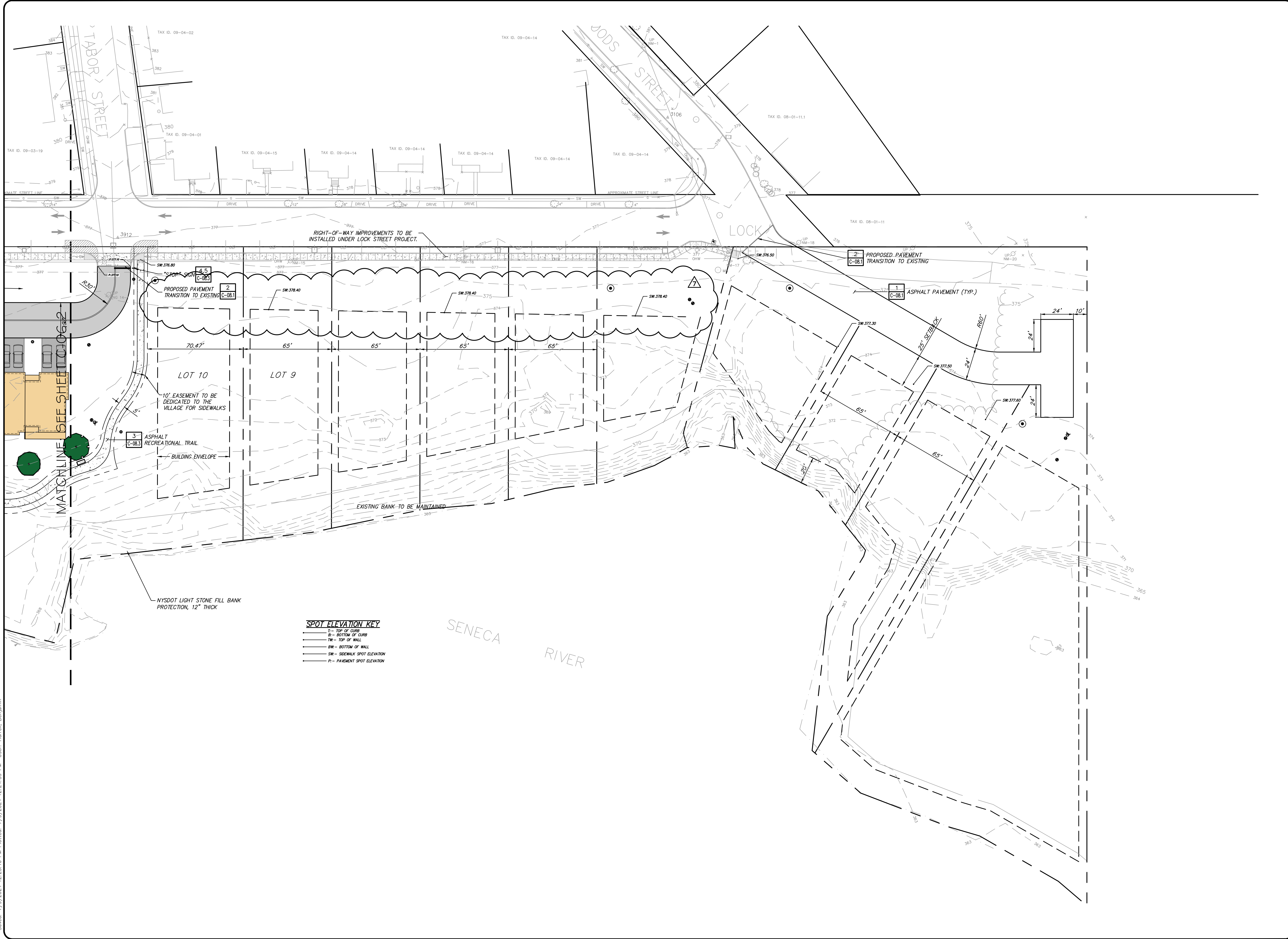

SPOT ELEVATION KEY

Tc	TOP OF CURB
Bc	BOTTOM OF CURB
Tm	TOP OF WALL
Bm	BOTTOM OF WALL
SW	SIDEWALK SPOT ELEVATION
P	PAVEMENT SPOT ELEVATION

No.	Submittal / Revision	By	App'd	Date
9	PDD Modification Initial Submission July 2024	BGH	JFT	7/9/24
8	Revised Trash Enclosure at Apartment Building	PBY	JFT	6/19

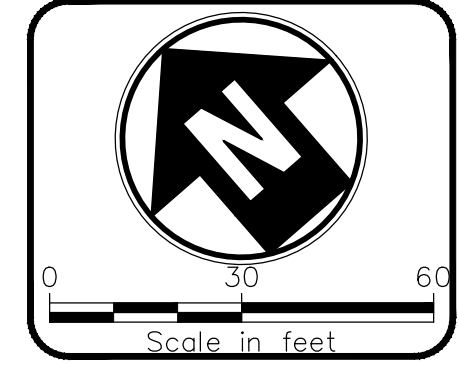

J. ALBERICI & SONS, INC.
 8266 WARBLER WAY, G-2
 LIVERPOOL, NEW YORK 13090

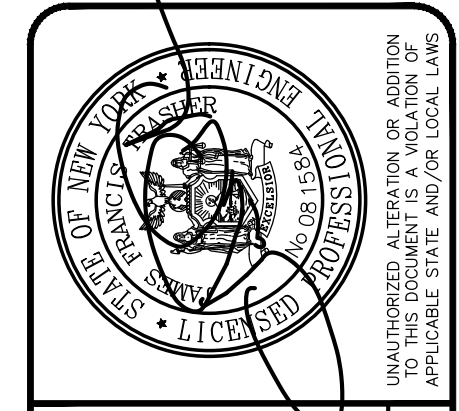

JMA
 Design Copyright © 2023
 One Park Plaza, 300 South St., 13th Floor, Suite 600
 316-471-3750 | www.jma.com

Designed: ZTP | Drawn: ZTP | Checked: JFT

FOBES ISLAND DEVELOPMENT
 VILLAGE OF BALDWINVILLE, COUNTY OF ONONDAGA, STATE OF NEW YORK
LAYOUT & GRADING PLAN - SINGLE FAMILY
 Issue Date: 1/26/15 | Project No.: 17076 | Scale: AS SHOWN

C-7.1